

# KENT PLACE SUMMER 2024 DROP-OFF, PICK-UP, & PARKING

Kent Place remains a very active campus during the summer months, hosting a variety of wonderful programs for all ages. Our campus plan calls for a project that will be completed over the summer: a new and improved entryway, visitor parking, and driveway loop into and out of the school at 42 Norwood Avenue.

This summer, the entrance to 42 Norwood Avenue will be closed, and our pick-up and drop-off procedures will change. Please read our FAQs to ensure a smooth transition.

## **What programs does this pertain to?**

Swax Lax, Passport Program, Senior Camp, Girls' Leadership Institute (all grades), Ethics Institute (e.g., Bioethics), Summer Enrichment (e.g., golf), and International Ivy.

## **Where will drop-off and pick-up take place?**

For the programs listed above, during drop-off, all cars should enter the campus at 387 Morris Avenue. Cars will bear right to go behind the Mabie House, line up, and be ushered to six spots at the bus loop, where a greeter from your program will be there to help your student/camper. The same procedure will occur for drop-off.

## **What if my child is in a half-day program or if I need to pick up early?**

Cars should enter at 387 Morris Avenue and go directly to one of the six spots at the bus loop.

## **Can I park and walk my child to their program?**

Unfortunately, parking this summer is extremely limited, and we will not be able to accommodate anyone walking their child on campus. If there is a special circumstance, we suggest speaking with your program's director.

## **What about Pre-K June Fun, June Fun, June Expeditions, Little Explorers, Pre-K Camp or Junior Camp and Extended Day Care?**

Drop-off and pick-up for these programs will not change; they will continue to use the Primary School entrance off at 80 Norwood Avenue.

## **Will our programs still have access to the Field House and fields?**

Yes, they'll have access to the Field House and fields. Designated pathways will lead around the fenced-in construction to those facilities.

# DROP-OFF, PICK-UP, & PARKING MAP

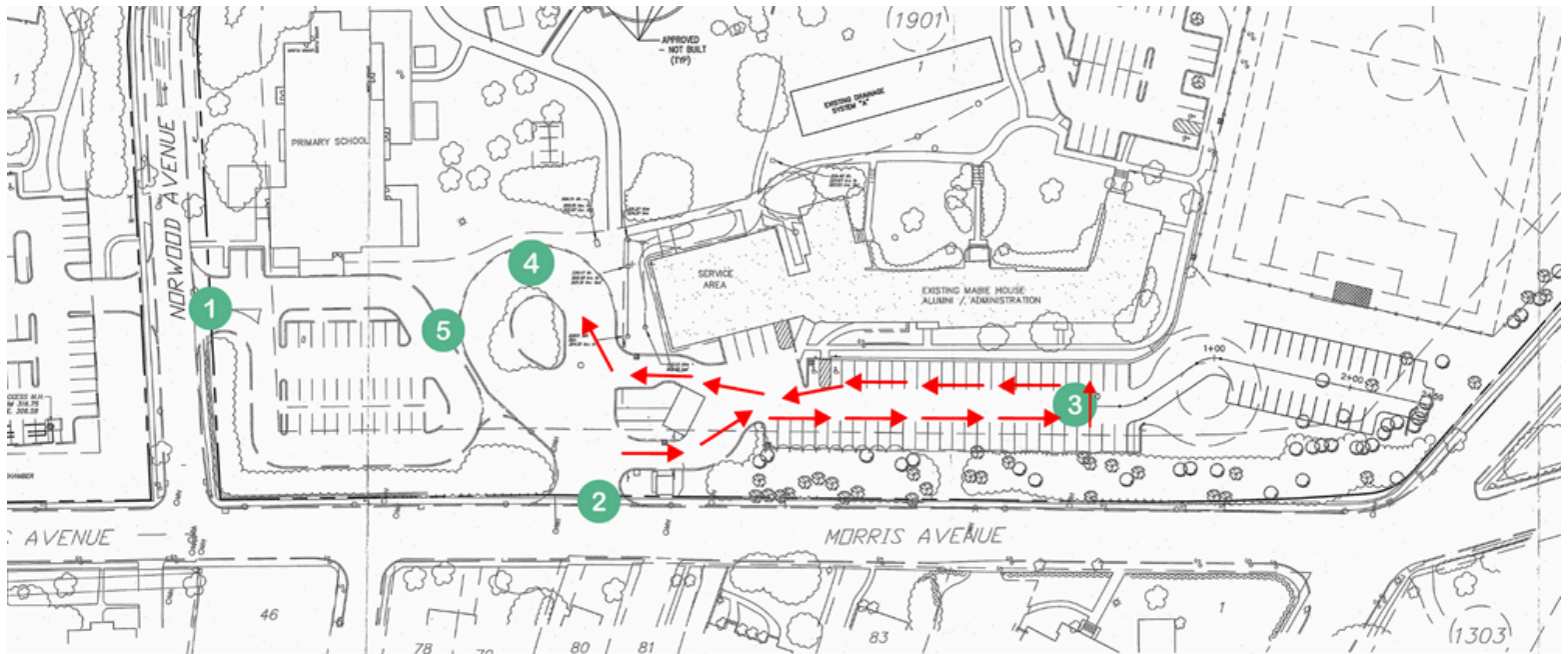

**1** Primary School Entrance for Pre-K June Fun, June Fun, June Expeditions, Little Explorers, Pre-K Camp or Junior Camp and Extended Day Care

**2** 387 Morris Avenue Entrance for All Other Summer Programs

**3** Drop-Off and Pick-Up U-Turn (Behind Mabie House)

**4** Bus Loop: Designated Spots for Arrival and Departure, Late Arrivals, Half-Day

**5** Campus Security Kiosk